

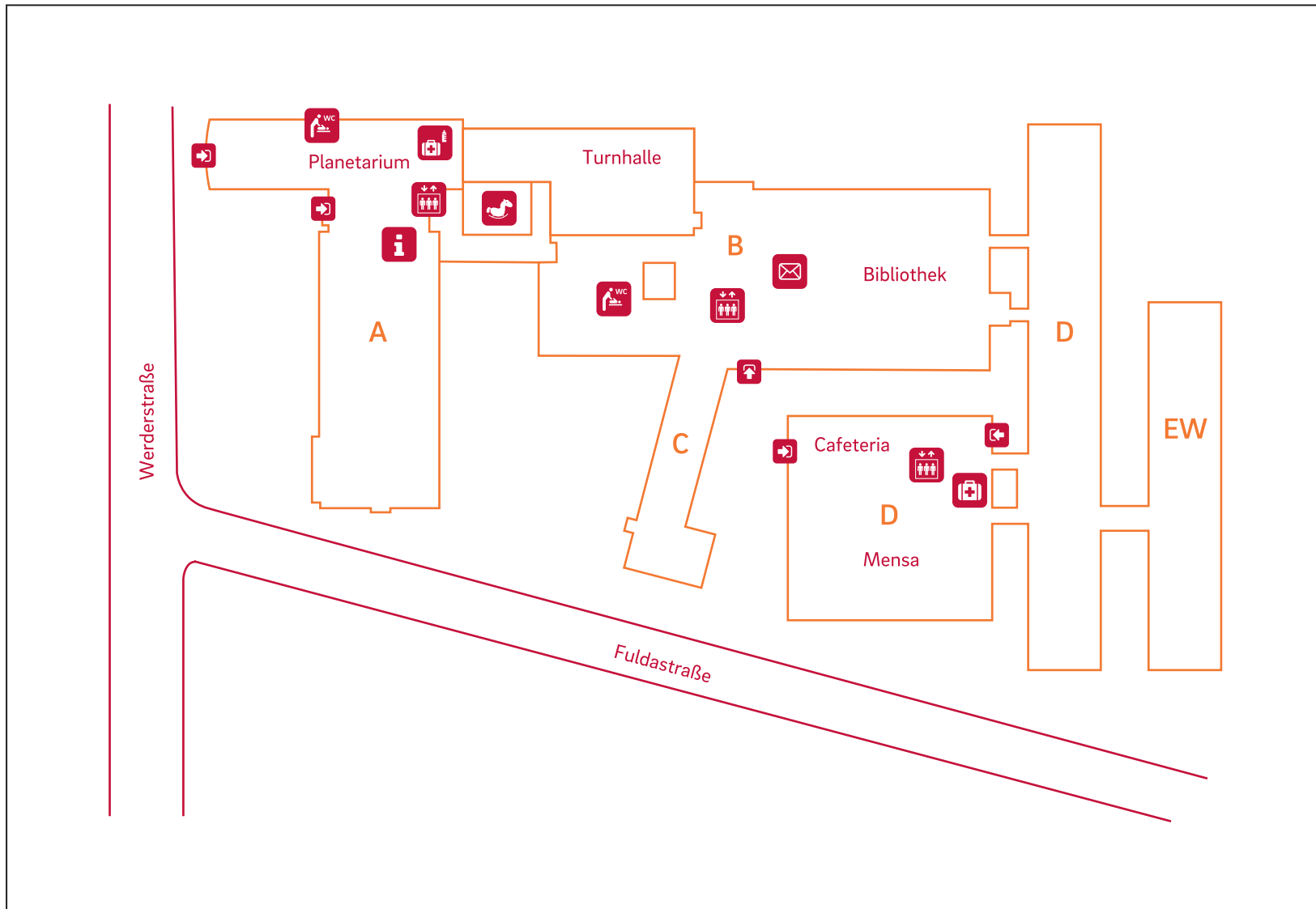

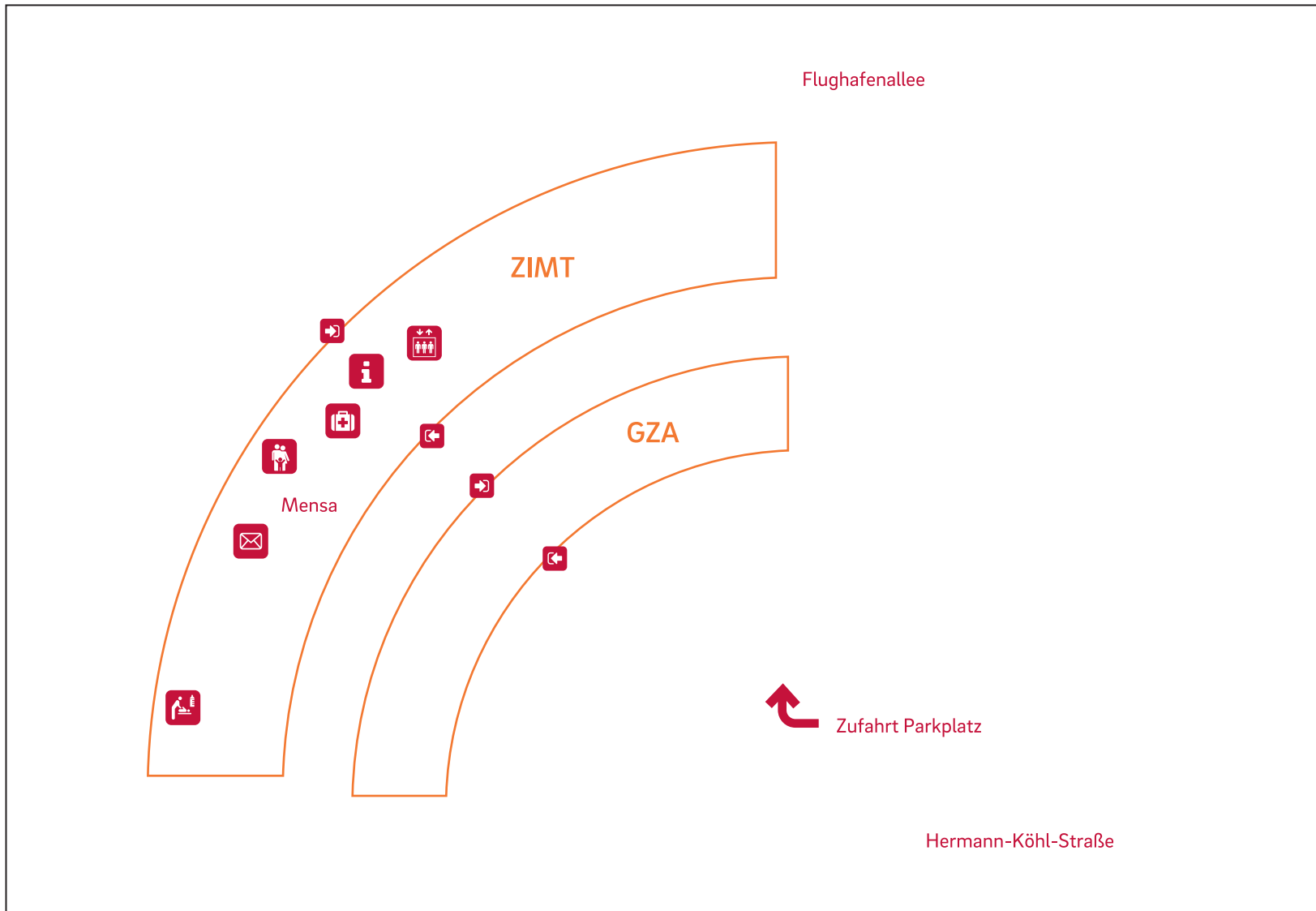



-  **Information**
-  **Familienbüro**
SI → 1. OG, 155
-  **Kinder-WC / Wickelraum**
AB → EG, 32a
-  **Stillzimmer / Wickelraum**
-  **Erste-Hilfe-Raum / Stillzimmer**
E → 2.OG, 226
M → EG, 04
UB → Keller, 02
IGC → EG, L.005
-  **Feedbackbox / Familienkiste**
-  **Spielecke**
-  **Aufzug**
-  **elektr. Türöffner**



-  **Information**
-  **Kinder-WC / Wickelraum**
 - Damen-WC
 - A → EG, 03
 - A → 2.OG, 209
 - B → 1.OG, 126
 - Herren-WC
 - A → EG, 06
 - A → 2.OG, 207
 - B → 1.OG, 119
-  **Erste-Hilfe-Raum / Stillzimmer**
 - A → 1.OG, 109
-  **Erste-Hilfe- / Ruheraum**
 - D → EG, 50A
-  **Feedbackbox / Familienkiste**
-  **Flummi**
-  **Aufzug**
-  **elektr. Türöffner**



-  Information
-  Stillzimmer / Wickelraum
1. OG, 112
-  Eltern-Kind-Zimmer
EG, 04
-  Feedbackbox / Familienkiste
-  Erste-Hilfe- / Ruheraum
2. OG, 227
-  Aufzug
-  elektr. Türöffner